

# STI WIRELESS CHIMES



STI-3350



STI-3610



STI-3300



STI-3360

## PRODUCT OVERVIEW

STI Wireless Chimes greet your visitors with a pleasant chime and let you know when the door opens or a person enters the detection zone. All chimes are compatible with each other. Distinguish between front and back doors by adding transmitters and selecting a different chime on each. Transmitters have up to 500' operating range (line of sight).

## HOW IT WORKS

### Wireless Doorbell Chime (STI-3350)

Mount the wireless button next to your door, plug the receiver into any 120 VAC indoor electrical outlet and the chime is ready to operate. Doorbell button is water-resistant.

### Wireless Entry Alert® Chime (STI-3360)

Mount the small transmitter and magnet to any door and plug the receiver into any 120VAC indoor electrical outlet. That's it. No wiring required. When a monitored door opens, the Entry Alert Chime sends a signal to the receiver announcing the entrance with one of ten selectable chimes.

### Wireless Motion-Activated Chime (STI-3610)

Mount the motion transmitter and plug chime receiver into any 120VAC indoor electrical outlet within operating range. Alerts when someone enters the transmitter's detection zone. The weather sealed transmitter has 140° x 40 ft. detection zone. Includes adjustable mounting bracket.

### Wireless Doorbell Extender (STI-3300)

This doorbell chime connects to your existing traditional hard wired doorbell system and extends a new chime to hard-to-hear areas. Once the unit is wired into existing system, the included receiver can be plugged into any standard 120VAC indoor electrical outlet. This allows you to hear when someone is at your door when in remote areas. Normally open switch, 16 VAC.

## KEY FEATURES

### General Information

- All chimes are compatible with each other.
- Add up to 10 transmitters per receiver.
- Up to 500' operating range (line of sight).
- Ideal for the home, store or office.
- One year limited warranty.

### Construction

- UL/cUL Listed, FCC and IC Certified.

### Installation

- Quick and easy to install – no wiring needed (excluding STI-3331).
- Receiver plugs into 120 VAC outlet.

### Electronics

- Receiver has a low and high volume adjustment.
- Supervised low battery alert.

### Options

- 10 sound options with the push of a button on the transmitter (excludes STI-3331).
- STI-3300 can distinguish between a front and back door. The first doorbell will play "ding-dong" and the second will play "dong."

# STI Wireless Chimes

## Dimensions and Technical Information

### MODELS AVAILABLE

<b>STI-3350</b>	Wireless Doorbell Chime with Receiver
<b>STI-3360</b>	Wireless Entry Alert® Chime with Receiver
<b>STI-3610</b>	Wireless Motion-Activated Chime with Receiver
<b>STI-3300</b>	Wireless Doorbell Extender with Receiver

### Accessories

<b>STI-3301</b>	Wireless Doorbell Chime Transmitter
<b>STI-3551</b>	Wireless Entry Alert® Transmitter
<b>STI-3601</b>	Wireless Motion-Activated Transmitter
<b>STI-3331</b>	Wireless Doorbell Extender Transmitter
<b>STI-3353</b>	Wireless Chime Receiver

### Selectable Sounds (*excludes 3300/3331*)

Ding  
Dong  
Ding-Dong  
Westminster – 4 note  
Westminster – 8 note  
Knock Knock  
Jingle Bells  
Barking Dogs  
Bicycle Bell  
Buzzer

### APPROVALS & WARRANTY

#### TESTING

It has been tested and approved or listed by:  
· UL/cUL Listed No. S7255 (excludes STI-3300, STI-3331)  
· FCC and IC Compliant

#### WARRANTY

One year limited warranty within normal use.

#### SPECIFICATIONS

**Frequency:** 433 MHz

**Power Source:** Receiver plugs into 120 VAC outlet  
(minimum 110 VAC)

#### Sensors include:

<b>STI-3301</b>	One CR2032 battery
<b>STI-3551</b>	One AAA battery
<b>STI-3601</b>	One Lithium CR123 battery
<b>STI-3331</b>	Requires 16V power

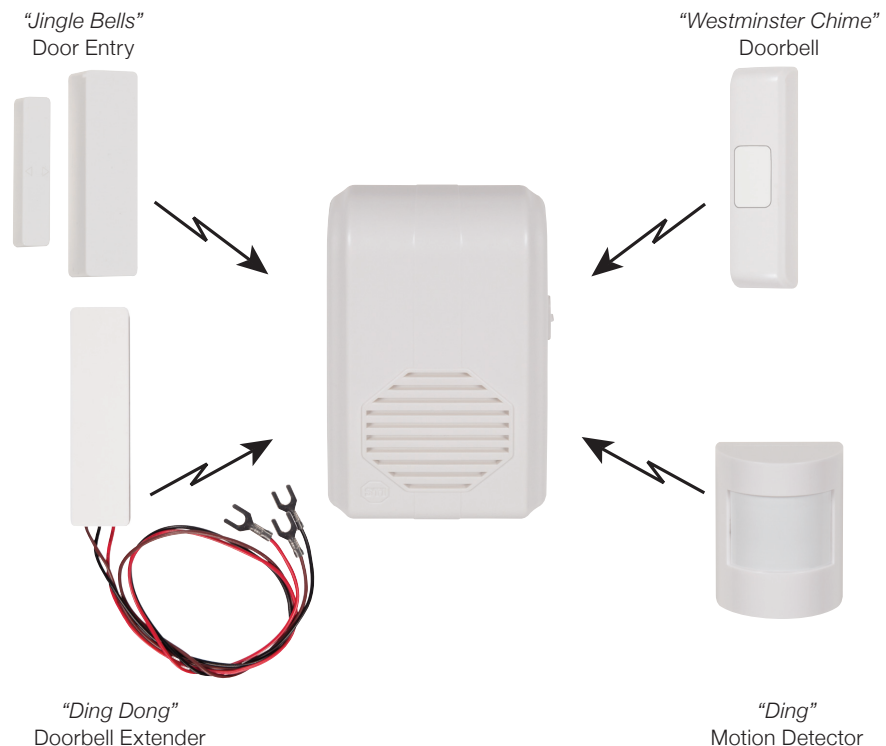

**All accessories work together!  
Make each a different sound and know the exact transmitting source.**



**Safety Technology  
International**

2306 Airport Road info@sti-usa.com  
Waterford, MI www.sti-global.com  
48327, USA Tel: 248-673-9898

Taylor House info@sti-emea.com  
34 Sherwood Rd., Bromsgrove, www.sti-global.com  
Worcs., B60 3DR, England Tel: +44 (0) 1527 520 999

Unit 7A Lockheed Avenue  
Airport Business Park  
Waterford X91 HWF2 Ireland