

PC-3CL

CEILING SPEAKER



The PC-3CL is a completely-sealed, flush-mounted ceiling speaker made up of a high power handling, splash-proof, small full-range speaker employing a plastic film diaphragm. Its chemical-resistant grille makes the speaker ideal for use in clean rooms, hospital operation rooms, and hot and humid locations such as bath rooms and wet sauna rooms.

Key features

- Clean room / shower room speaker
- Resistant against formalin and iodine solutions
- Wide temperature range of -20 °C to 60 °C

Specifications

Rated Input	3 W
Rated Impedance	100 V line: 3.3 k Ω (3 W), 10 k Ω (1 W) 70 V line: 3.3 k Ω (1.5 W), 10 k Ω (0.5 W)
Sensitivity	87 dB (1 W, 1 m)
Frequency Response	150 Hz - 20 kHz
Speaker Component	8 cm cone-type (vibration section: high molecular substance)
Mounting Hole	Ø100 mm (Ceiling panel: Must be over 5 mm in thickness, equivalent to plywood in material, and strong enough to hold tapping screws.)
Chemical Resistance	Resistive to formalin solvent and iodine liquid (disinfectant)
Dust/Water Protection	IP64
Operating Temperature	-20 °C to +60 °C (-4 °F to 140 °F)
Finish	Panel: Allory-coated ABS resin Enclosure: ABS resin Punching net: Stainless steel
Dimensions	Ø139 x 104.5 (D) mm
Weight	550 g
Included Accessories	Packing (Material: Silicon rubber) x 1, Paper pattern x 1, Ceiling mounting tapping screws (Material: Stainless steel) x 4

Note: The speaker cannot be used in dry sauna rooms or locations where unit is splashed with water.

Dimensions

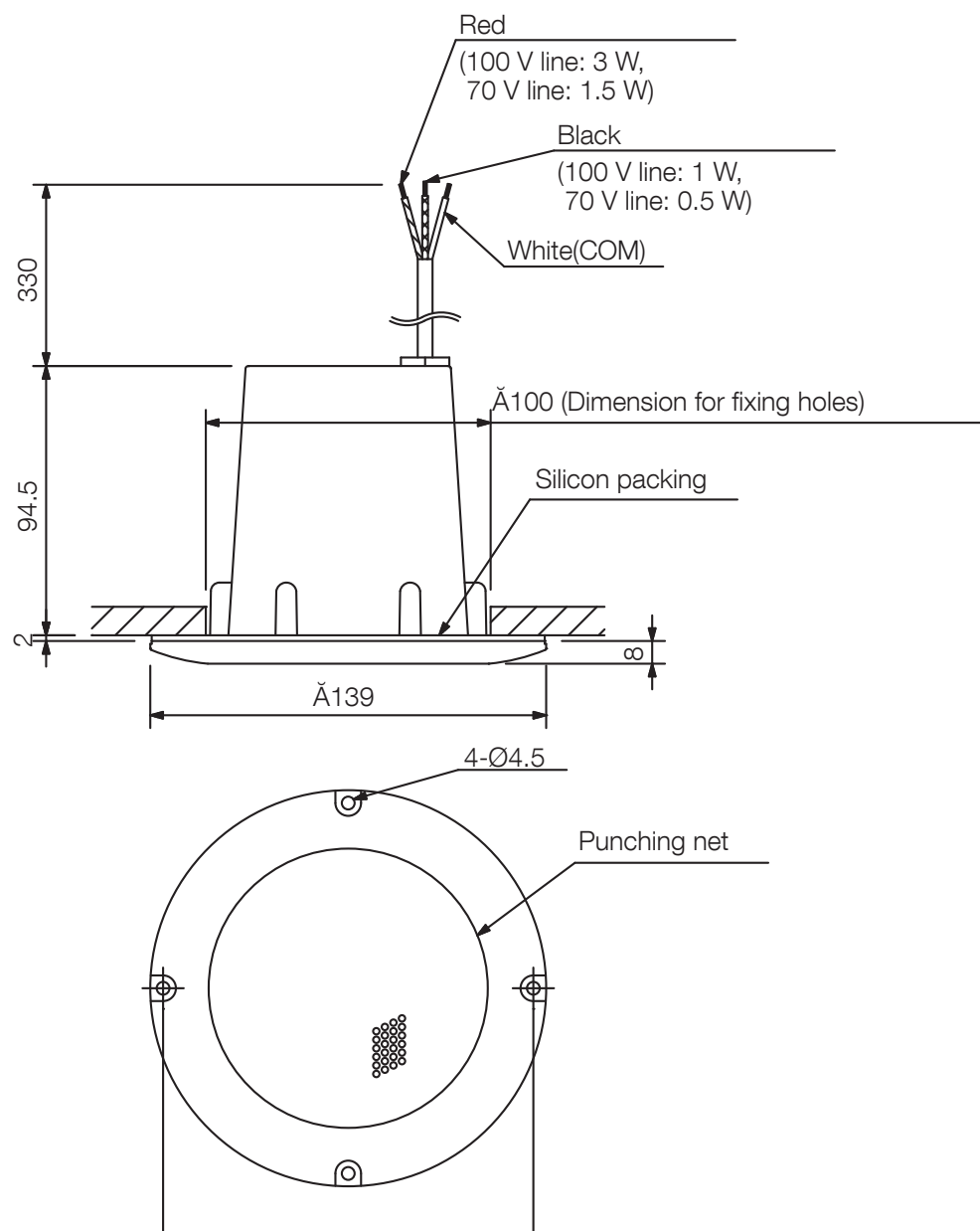

UNIT:mm

SCALE:1/3

A&E specifications

The speaker shall be suitable for use in humid and/or high temperature applications. The speaker shall include a 3.5" (8 cm) full-range cone driver and built-in 100V matching transformer with 1.5 W and 0.5 W taps. Sensitivity shall be 87 dB SPL (1 W / 1 m) and frequency response shall be 150 to 20k Hz. The speaker shall be operable within the temperature range of -20 °C to +60 °C (-4° F to +140° F).

The splash-proof speaker shall be TOA model PC-3CL.