

Bluetooth® Access Controller

PR-B1124-PQ Proximity Card Reader

Streamlined, fully app-based setup using integrated Bluetooth® wireless technology. No codes to remember with an intuitive app designed for easy, visual programming as well as convenience and security for the user and administrator. All data is secured on the device without the risks inherent in an internet connection.

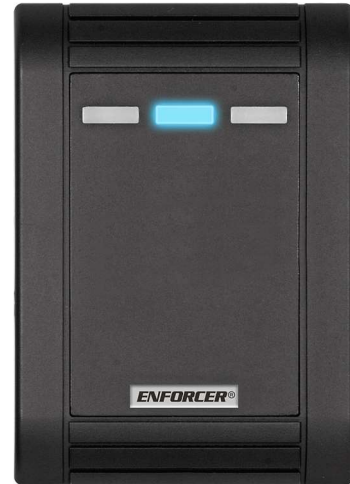

Features

- **No Codes to Remember** – Intuitive, visual app-based programming and management, 1,000 users, device options, etc.
- **More Than Access** – Can control doors, gates, lighting, machinery, etc.
- **No Internet Exposure** – All data secured locally on device
- **Multiple User Types** – Permanent, scheduled, temporary, # of times
- **Output Modes** – Timed relock, continually unlocked or locked, toggle
- **User Customization** – Individually customizable output mode and time
- **Hold Open** – Hold door open with code or app (customizable)
- **Secure, Integrated Bluetooth** – Passcode protected, AES 128 encryption
- **Unlimited Devices** – Access/manage unlimited devices with one app
- **Easy Backup/Restore** – For off-device storage / restoration / replication
- **Wrong-Code Lockout and Tamper Alarm Output** – Customizable
- **Multilingual App Interface** – Currently supports English, Spanish, Portuguese, French, German, Russian, Vietnamese, and Chinese (Traditional or Simplified)

App-Based Setup

No Internet Exposure

1,000 Users

Audit Trail

SL Access™ App



App-Based Management and Control

On-Device Security

AES 128 Encryption
Settings, passcodes kept on device, set by the Administrator



Administrator Settings

Set all device parameters, manage users, view audit trail, backup/restore

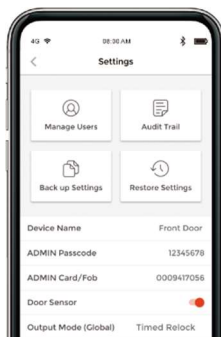

User Management

Add, view, import/export, customize individual settings, scheduling, output settings

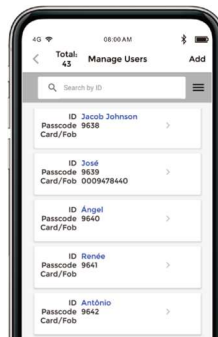

Audit Trail

View most recent 1,000 events, searchable by user and type, and download for archive

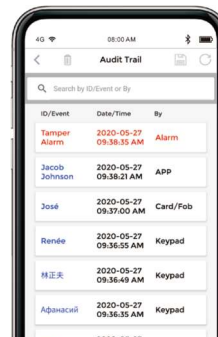

Unlock with App

Users can unlock the door with the app, as well as with the proximity card



SECO-LARM® U.S.A., Inc.

16842 Millikan Avenue, Irvine, CA 92606

Phone: (949) 261-2999 | (800) 662-0800 Fax: (949) 261-7326

Website: www.seco-larm.com Email: sales@seco-larm.com



Copyright © 2025 SECO-LARM U.S.A., Inc. All rights reserved.
All trademarks are the property of SECO-LARM U.S.A., Inc. or their respective owners.
The SECO-LARM policy is one of continual development. For that reason, SECO-LARM reserves the right to change prices and specifications without notice. SECO-LARM is not responsible for misprints.

SECO-LARM® ENFORCER® CRIMEBUSTER® CBA® SLI®

PL_PR-B1124-PQ_250207.docx

Specifications

Access modes		App / proximity card
Users		1,000 users / 1 administrator
Operating voltage		9~25 VDC
Current draw	Standby	55mA@12VDC, 30mA@24VDC
	Active (max.)	100mA@12VDC, 50mA@24VDC
Outputs	Form C	2.0A@30VDC
	Tamper alarm	100mA@30VDC (solid state N.C.)
Output modes		Timed relock (1~1,800s), continually locked, continually unlocked, toggle
Inputs	Egress	N.O. Ground
	Door sensor	N.C. Ground

Tamper sensor	Vibration detector
Electrical protection	Short circuit, electrostatic discharge, reverse polarity, relay contact protection
Bluetooth version	Bluetooth Low Energy (BLE) 4.2
Proximity frequency	EM 125kHz
IP Rating	IP65 Weatherproof
Operating humidity	0-95%, non-condensing
Operating temperature	-4°~122° F (-20°~50° C)
Material	ABS Plastic
Dimensions	3 1/8"x4 1/2"x1 1/16" (80x114x18 mm)
Weight	6.3-oz (180g)

Two Ways to Unlock or Trigger a Device

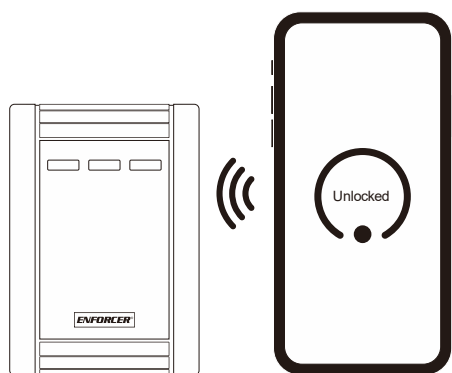

Unlock with the app

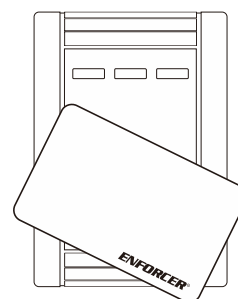

Unlock with a proximity card

Dimensions

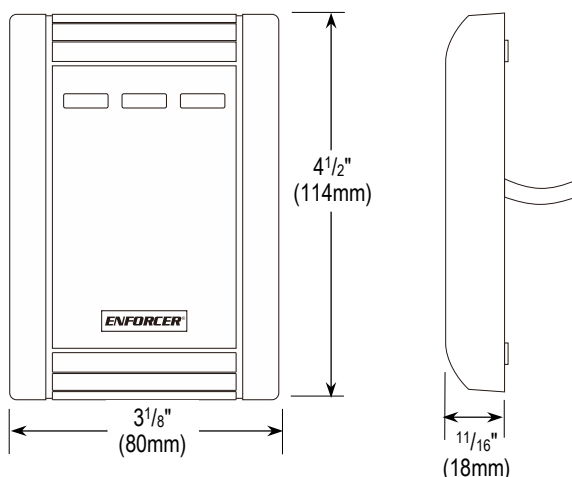

Download the SL Access™ App

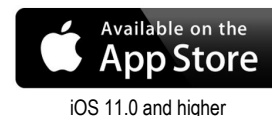

The Bluetooth® word mark and logos are registered trademarks owned by Bluetooth SIG, Inc. and any use of such marks by SECO-LARM is under license. Other trademarks and trade names are those of their respective owners.