

# 3/4" End Cap

## PRODUCT SPECIFICATION

### Package includes:

A. 3/4" End Cap, 10 pcs

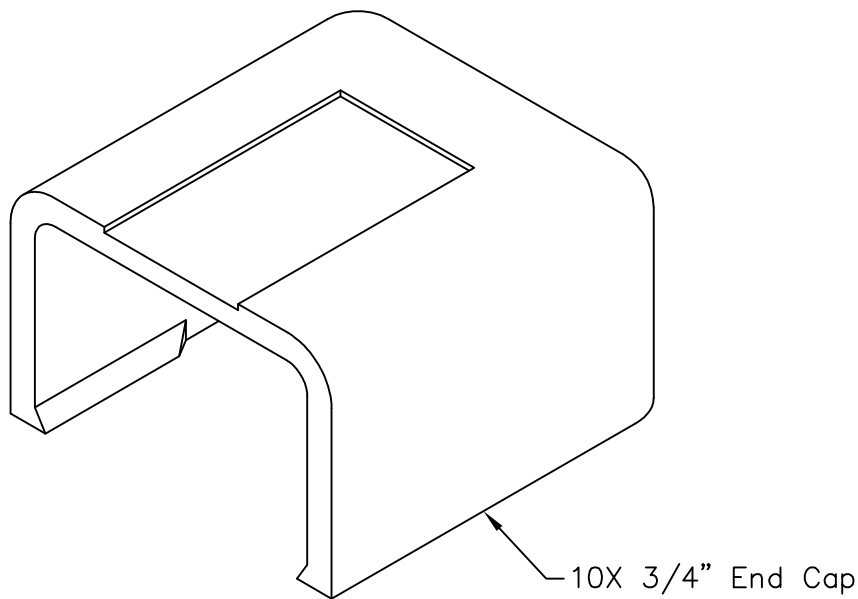

### Features and Benefits:

- Designed to protect raceway ends
- Accommodates ICRW22R, ICRWR118, and ICRWR11S 3/4"W x 1/2"H raceway sections
- Available in ivory and white

### END CAP, 3/4", 10 PK

ITEM NO. ICRW11ECXX

REV. A

DWG NO. PSRW11EC00

PAGE NO. 1



CUSTOMER CARE / TECHNICAL SUPPORT \* CSR@ICC.COM / 888-ASK-4-ICC (275-4422) \* 2100 E. Valencia Dr, Suite D, Fullerton, CA 92831 \* www.icc.com

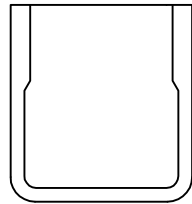
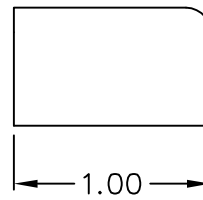
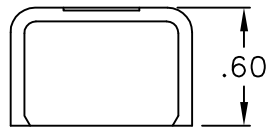
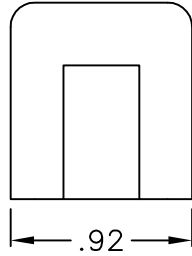

**NOTE: UNLESS OTHERWISE SPECIFIED**

1. MATERIAL: HIGH IMPACT STYRENE
2. COLOR: XX: IV-IVORY & WH-WHITE

**END CAP, 3/4", 10 PK**

ITEM NO. ICRW11ECXX

REV. A

DWG NO. PSRW11EC00

PAGE NO. 2



CUSTOMER CARE / TECHNICAL SUPPORT \* CSR@ICC.COM / 888-ASK-4-ICC (275-4422) \* 2100 E. Valencia Dr, Suite D, Fullerton, CA 92831 \* www.icc.com